

Iowa Prison Industries

Iowa Board of Regents

August 8, 2013



081 XPK

083 XPK

083 XPK

084 XPK

084 XPK

LOWE'S
085 XPK

“Statement of Intent for Prison Industries”

(Iowa Code §904.801)

“To develop **Positive Attitudes** which will enable offenders to eventually function as law-abiding, self-supporting members of the community”



“**Good work habits** that will assist them in eventually securing and holding gainful employment outside the correctional system”



“To the extent feasible, **marketable skills** that can lead directly to gainful employment upon release from a correctional institution.”



“Provide for their dependents,
thus tending to strengthen the inmates’
family ties while reducing the likelihood
that inmates’ families will have to rely
upon public assistance”



“**Make restitution** to the victims of the offenses for which the inmates were incarcerated, so as to assist the inmates in accepting responsibility for the consequences of their acts”



“Pay some portion of the cost of board, in a manner similar to what would be necessary if they were employed in the community”

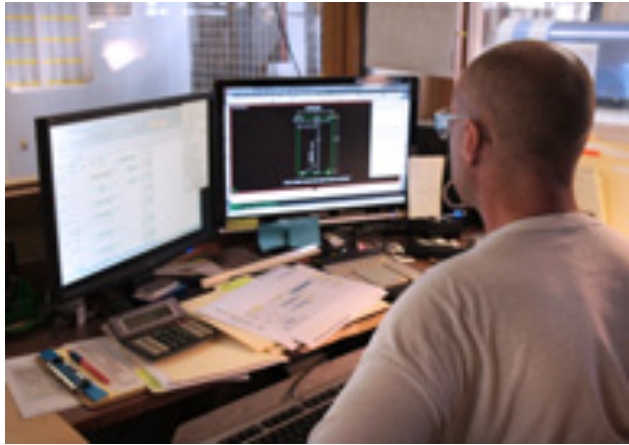

“**Accumulate savings** so that such inmates will have funds for necessities upon their eventual return to the community”



ROCKWELL CITY

North Central Correctional Facility

Traditional Industries: Prison Cells, Welding, Assembly

Private Sector: Telemarketing, Trailers, Silk Screening

Farms: Row Crops

FORT DODGE

Fort Dodge Correctional Facility

Private Sector: Pontoon Boats

CLARINDA

Clarinda Correctional Facility

Private Sector: Cargo Trailers

DES MOINES

Sales Office: Showroom, Customer Service, Sales, Marketing

Traditional Industries: State & Federal Surplus, Moving & Installation

MITCHELLVILLE

Iowa Correctional Institute For Women

Traditional Industries: Chairs, Upholstery, Modular Systems, Textiles, CD Archiving, Picture Frames, Data Entry, Chemicals, Plastics, Embroidery, Garment Printing

Farms: Row Crops

NEWTON

Newton Correctional Facility

Traditional Industries: Canteen

Private Sector: Printing, Truck Wash

Farms: Row Crops, Cattle

ANAMOSA

Anamosa State Penitentiary

Traditional Industries: Welding, Wood, Chemicals, Printing, Braille, License Tags, Signs, Filters

Farms: Row Crops, Cattle

Business Office: Purchasing, Accounts Receivable/Payable

MOUNT PLEASANT

Mount Pleasant Correctional Facility

Traditional Industries: Dorm Furniture

FORT MADISON

Iowa State Penitentiary

Traditional Industries: Dorm Furniture, Wood, Textiles, Tourism, Refinishing

Farms: Row Crops, Cattle, Trees

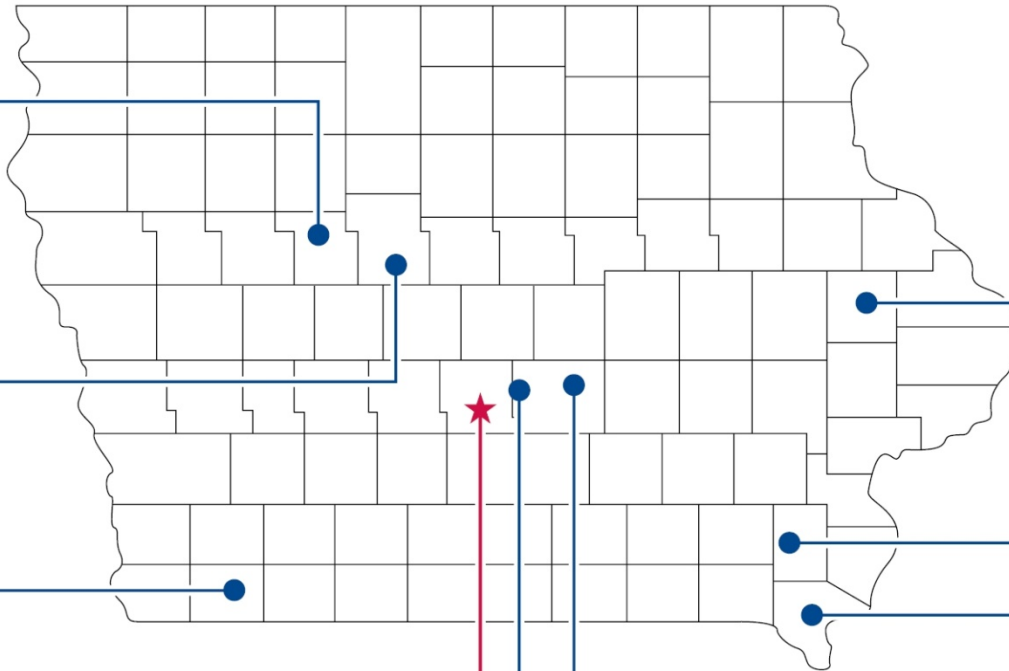



ISU & IPI

BFF !

Residence Hall Furniture

- ▶ Loft beds, desks, wardrobes, etc
- ▶ Designed in conjunction with DOR
- ▶ 49,000 pieces since 1999
- ▶ Move & Install teams



Fredrickson Court, ISU



Office, Classroom, Dining Hall Projects



Clyde's, ISU



President Leath's Office, ISU



ISU Interns @ IPI



- ▶ **Dan Neubauer**
 - Summers 2012 & 2013
 - Studying for Masters in Industrial Design
 - Designing furniture



- ▶ **Meredith Van Woert**
 - Spring 2013
 - Studying for Bachelors in Apparel, Merchandising & Production
 - Redesigned denim jeans



- ▶ **Madison Romano**
 - Summer 2013
 - Studying for Bachelors in Product Development for Fashion Design
 - Optimizing jean production



- ▶ **Holly Kayser**
 - Summer 2013
 - Studying for Bachelors in Graphic Design
 - Designing product brochures, annual reports, logos



- ▶ **Levi Ward**
 - Summer 2012
 - Studying for Bachelors in Graphic Design
 - Designing product brochures, annual reports, newsletters



Daniel Alexander Neubauer

Furniture Design Intern

THE ALEXANDER LINE

A New Range Of Modular Furniture
Designed and Manufactured by Iowa Prison Industries

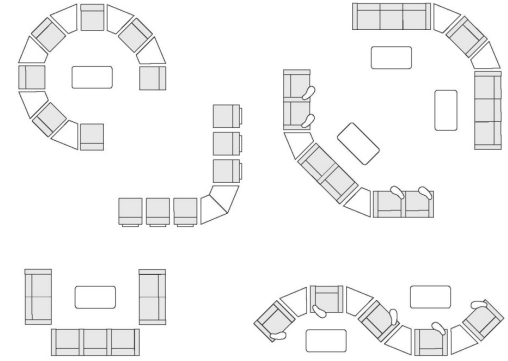

Iowa Prison Industries
A Division of The Department of Corrections
800-670-4537 • www.iaprisonind.com



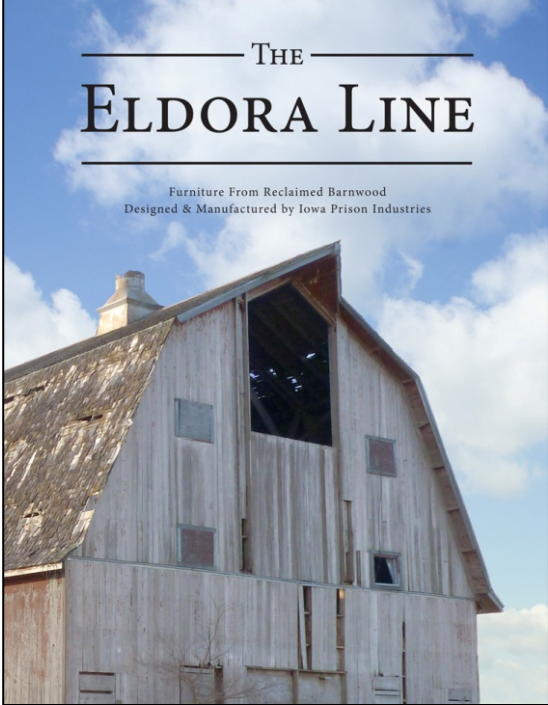

THE
ELDORA LINE

Furniture From Reclaimed Barnwood
Designed & Manufactured by Iowa Prison Industries



THE ELDORA LINE

Furniture From Reclaimed Barnwood
Designed & Manufactured by Iowa Prison Industries



Levi Ward

Graphics Design Intern

ORIGINS OF THE ELDORA LINE

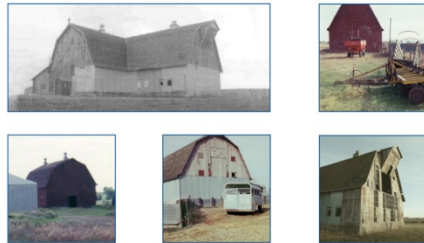

In 1868, Iowa Governor Samuel Merrill signed a bill creating a reform school for delinquent boys, known as the Boys Training School. The General Assembly appropriated \$45,000 for the purchase of land and the construction of suitable buildings. Cities and counties throughout Iowa submitted offers and incentives, with Eldora winning the contest and donating 400 acres of land. Buildings were established, including residence houses, classrooms, a dining hall, hospital, chapel, workshops, warehouses, and barns.

The largest of these barns measured 60 feet wide by 120 feet long and was split into two cross sections, with an alley running the length of the barn. An extension to the north held a vocational agriculture classroom, feed rooms, offices, and a milk room. The basement was used for storage.

Over time, a number of the barns and outbuildings lost their usefulness and had to be taken down. But rather than simply razing the structures, Iowa Prison Industries and Iowa Central Community College worked together and "deconstructed" the barns, reclaiming valuable timber and other materials.

As part of the deconstruction program, offenders from the North Central Correctional Facility in Rockwell City attended classroom training and studied to become certified in areas such as asbestos handling, lead paint abatement, and OSHA safety. Under the supervision of ICCJ and IPI, these offenders carefully dismantled Eldora's barns and outbuildings, yielding a treasure trove of old growth Douglas Fir - the fine wood used by IPI to craft the new "Eldora Line" of furniture.

FROM FARM TO FURNITURE



CONFERENCE TABLE

- Solid wood construction
- Boat-shaped design encourages participation
- Steel legs
- Concealed power cord channels are included
- Outlet grommet options available
- 42" x 120" x 30"



CREDENZA

- Solid wood construction
- Steel legs
- Adjustable shelf
- Magnetic spring doors
- 34" x 63" x 48"



OCCASIONAL TABLE

- Solid wood construction
- Steel legs
- 1.5" top
- Legs bisect at a subtle upward curve
- 21" x 21" x 19"

A CUSTOMIZABLE COLLECTION

In addition to pieces tailor-made for this collection, IPI can build custom furniture to your design, using the beautiful wood and rich history found in the Eldora Line.



ABOUT IOWA PRISON INDUSTRIES

Iowa Prison Industries (IPI) is the work arm of the Iowa Department of Corrections and consists of Traditional Industries (manufacturing), IPI Farms and Private Sector programs.

IPI provides work training in a real world setting, where offenders develop skills such as operating in a team environment, meeting quality requirements, and achieving output goals.

When they re-enter society, these offenders can have a resume, record of advancement, and skill certification such as welding, machining, or forklift operation. Ex-offenders from IPI provide Iowa companies with a trained and ready work force.

About 700 offenders "go to work" everyday in IPI programs, gaining over 1 million hours of work training per year.

Numerous studies have shown that work programs and vocational training significantly reduce the number of offenders that return to prison for new crimes (recidivism).

Since 90 percent of prison offenders will be released back into our communities, IPI's success in reducing recidivism means fewer crimes are committed, fewer citizens are victimized, and fewer offenders are housed at the taxpayers expense.



Iowa Prison Industries
A Division of the Department of Corrections
800-678-4537 • www.ipiinside.com



BUILDING BRIDGES TO SUCCESS

Iowa Prison Industries

FY2012 Annual Report



IPI Newsletter

www.iaprisonind.com

June 2012

IPI Showroom Building Wins Design Awards

ASK Studio of Des Moines has now won two awards for the design of the IPI Showroom in Des Moines, which opened for business in November 2009.

Most recently, ASK Studio received a Merit Award from *Residential Architect Magazine* in the light commercial division of the 2012 Residential Architect Design Awards. It is one of 36 winners selected from a group of more than 800 entries. The building received the award for its beauty in simplicity.

ASK Studio received a 2011 AIA Iowa Excellence in Design Award of Merit from the American Institute of Architects, Iowa Chapter, last September. One juror stated, "A well considered building that

makes the most of its budget through clever detailing and use of standard metal buildings systems." ASK Studio received extra press for this award, as it was highlighted in the January 2012 issue of the *Iowa Architect* under the article "A Good Neighbor" for its respect for the neighborhood.

The IPI Showroom in Des Moines was built within a strict budget and without any taxpayer funds. Since opening, the Showroom is visited daily by customers

looking to purchase our products and services. With samples of the majority of our standard products plus a host of custom-designed pieces, the Showroom demonstrates IPI's diversity, flexibility and commitment to quality and service. Many visitors to the Showroom comment on how impressed they are with quality products that IPI's offenders manufacture.



Photo courtesy of Cameron Campbell / Integrated Studio

Cost-Benefit Analysis Shows IPI Has An Excellent ROI

BY DAN CLARK
IPI DIRECTOR



Recently, The Iowa Department of Corrections has measured the Return On Investment (ROI) to taxpayers from criminal justice programs utilized by the State of Iowa. Using the "Results First" model, a nationally recognized, peer-reviewed tool developed by the Washington State Institute for Public Policy, IDOC calculated the ROI for various Iowa adult offender programs, including Iowa Prison Industries.

Cost-benefit analysis allows policymakers to make informed decisions about the effectiveness of programs and policies, and to compare the monetary benefits of a program or policy against costs over a period of time. If the benefits outweigh the costs, a program or policy is considered cost-effective. The Results First model is capable of examining the effect

of reducing the average daily prison population and reinvesting the money saved into evidence-based criminal justice programming. The intent of the model is to allow policymakers to test different combinations of program and policy choices to make the best use of taxpayer dollars, while protecting or even improving public safety.

In the model, costs and benefits are estimated over a ten-year time period and expressed in constant 2011 dollars (i.e., life-cycle, present values). The cost data and benefit calculations are based on actual Iowa data.

Benefits include the state and local resources avoided as a result of a program that reduces future crime, such as arrest, prosecution, jail, and corrections supervision. They also include crime victim benefits that are the monetized value of avoided victimizations as a result of the program, for example medical and mental health care expenses, property damage and

losses, and reduction in future earnings incurred by crime victims.

Since IPI is self supporting and receives no government appropriation, there are no Program Costs. But the model showed that for 2011, the average benefit over 10 years per offender served by Iowa Prison Industries was \$2,908. During 2011, 1,400 offenders participated in one of the IPI work programs, meaning that the total benefit to taxpayers and victims was a whopping \$4.1 million!

The Iowa Department of Corrections is committed to evidence-based practices, and this report represents the first product of the Iowa Results First Model. The report was prepared by Lettie Prell, Director of Research, Iowa Department of Corrections and Sarah Wittig Galgano, research assistant. The complete report is available at <http://www.doc.state.ia.us/research.asp>.

Dan

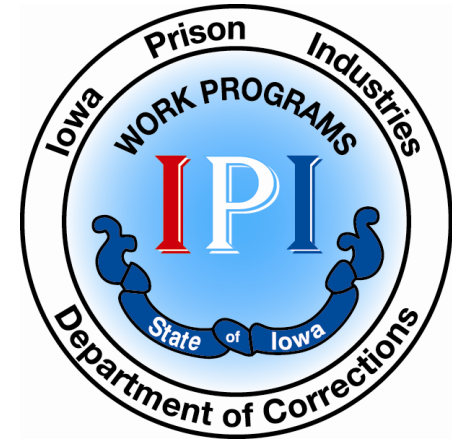

Iowa Prison Industries

Iowa Board of Regents

August 8, 2013

REDEFINING PRISON ENVIRONMENTS



IOWA DEPARTMENT OF CORRECTIONS
Iowa State University

Diann Wilder-Tomlinson | Iowa Department of Corrections
Julie Stevens | Landscape Architecture | Iowa State University



Existing Campus

Multipurpose Outdoor Classroom

Campus Expansion

Campus Expansion

Campus Expansion





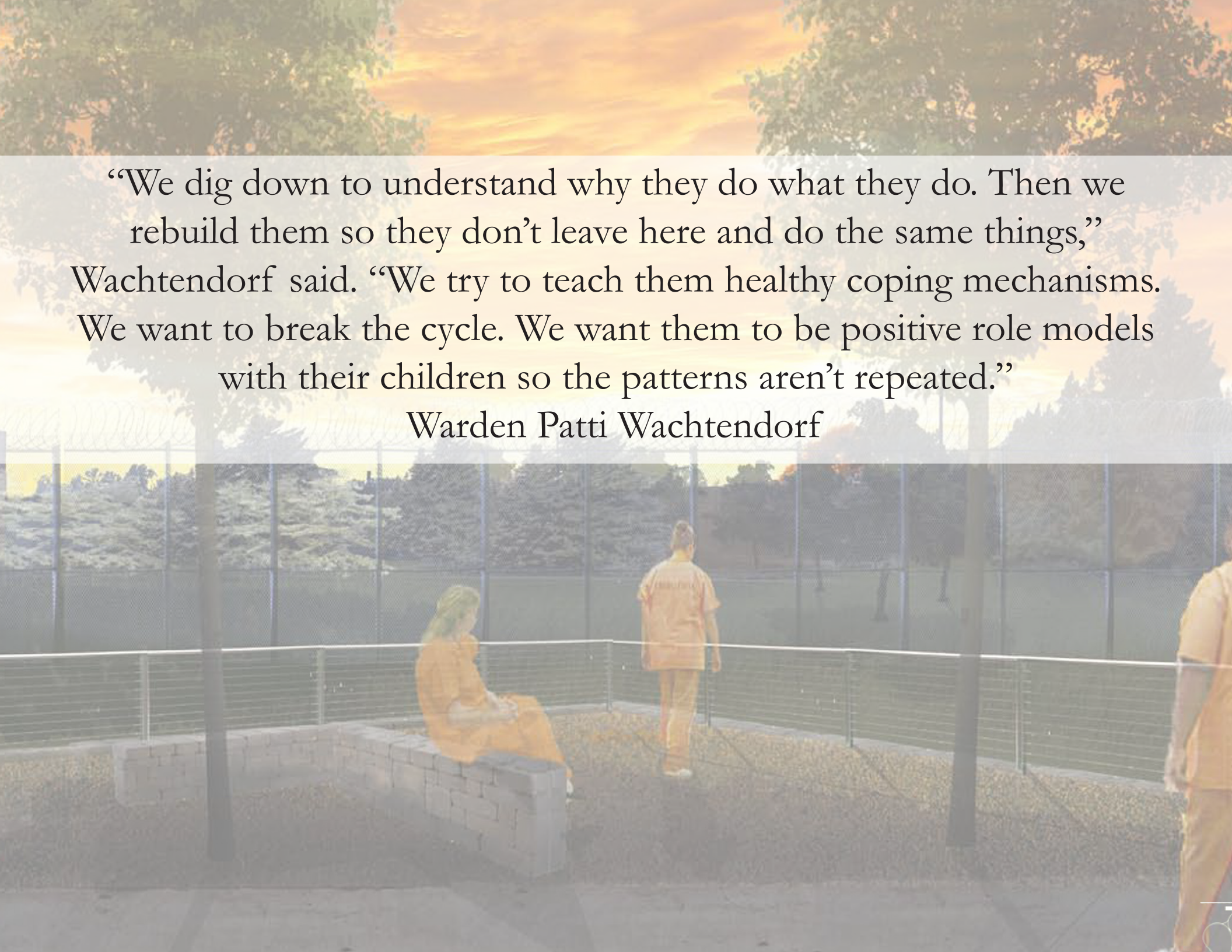

“We dig down to understand why they do what they do. Then we rebuild them so they don’t leave here and do the same things,” Wachtendorf said. “We try to teach them healthy coping mechanisms. We want to break the cycle. We want them to be positive role models with their children so the patterns aren’t repeated.”

Warden Patti Wachtendorf

IOWA CORRECTIONAL INSTITUTION FOR WOMEN: MASTER PLAN

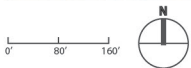
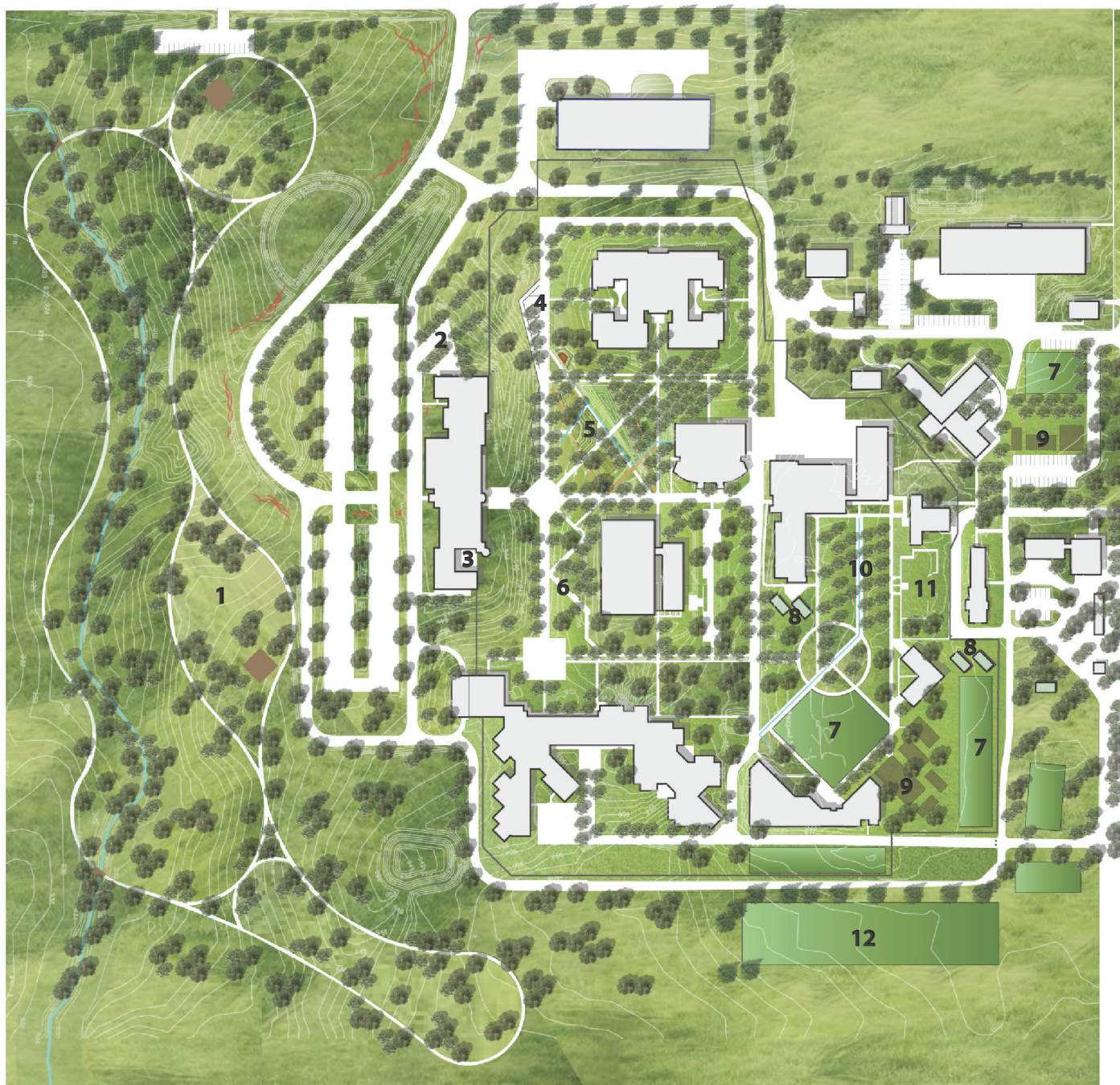

1. RESTORATION PARK

- Contributes to the health and well-being of the Mitchellville community and the ICIW staff
- Offers an improved wildlife corridor and overall ecosystem functions.
- Provides a shelterbelt for the ICIW campus
- Creates an attractive setting for art installations

2. DECOMPRESSION DECK

A place where Correctional Officers & ICIW Staff can take a break or share stories about their day

3. VISITOR COURTYARD

Provides an outdoor space that allows for personal interactions between the offenders and their guests as well as a play area for offenders with children

4. OVERLOOK

The best place to take in the sunset or await the arrival of loved ones for visiting hours

5. OUTDOOR CLASSROOMS

The multi-purpose outdoor classroom areas will serve many functions:

- Educational classes
- Small or large group counseling sessions
- Informal gatherings
- Large plays and performances

6. THE PARKWAY

Provides a place to exit the firelane. In the space, offenders can enjoy the view or connect with others in small groups. The position of the seating directs ones attention outside of the fence to the stream corridor beyond.

7. COMMUNITY & PRODUCTION GARDENS

The plots in the community garden mimic a home garden. Both gardens offer places where the offenders can learn vocational life skills to support successful reentry.

8. GREENHOUSES

Used for production propagation & vocational training.

9. RECREATION COURTS

Courts for a variety of activities provide more extensive recreational opportunities

10. THE GROVE

Provides a quiet respite & a space for yoga and meditation.

11. THE HERB GARDEN LABYRINTH

Combines the healing powers of aromatherapy with those associated with walking a labyrinth. The labyrinth may be used to support counseling.

12. TREE NURSERY

Vocational training opportunity for Minimum Liveout population. The offenders will learn how to grow trees that will be used throughout the site.

"The collaboration with the students has allowed the D.O.C. to provide female offenders with an amazing therapeutic environment that promotes personal growth, provides opportunities to heal both emotionally and medically, allows for accepting responsibility for their past actions, improving their education levels and participating in cognitive restructuring programs designed to reduce the rate of recidivism."

- Director Baldwin, Iowa Department of Corrections





“Working with the design team, staff and offenders at ICIW for the past two years has been a life-changing experience. It has been an honor to be part of such a unique project and exciting to have our design built.”

Garret Munch - Student Designer ISU '12



“We’ve really learned how design translates into construction. It’s helped us think about how something will be constructed and experienced,”

Student Reflection

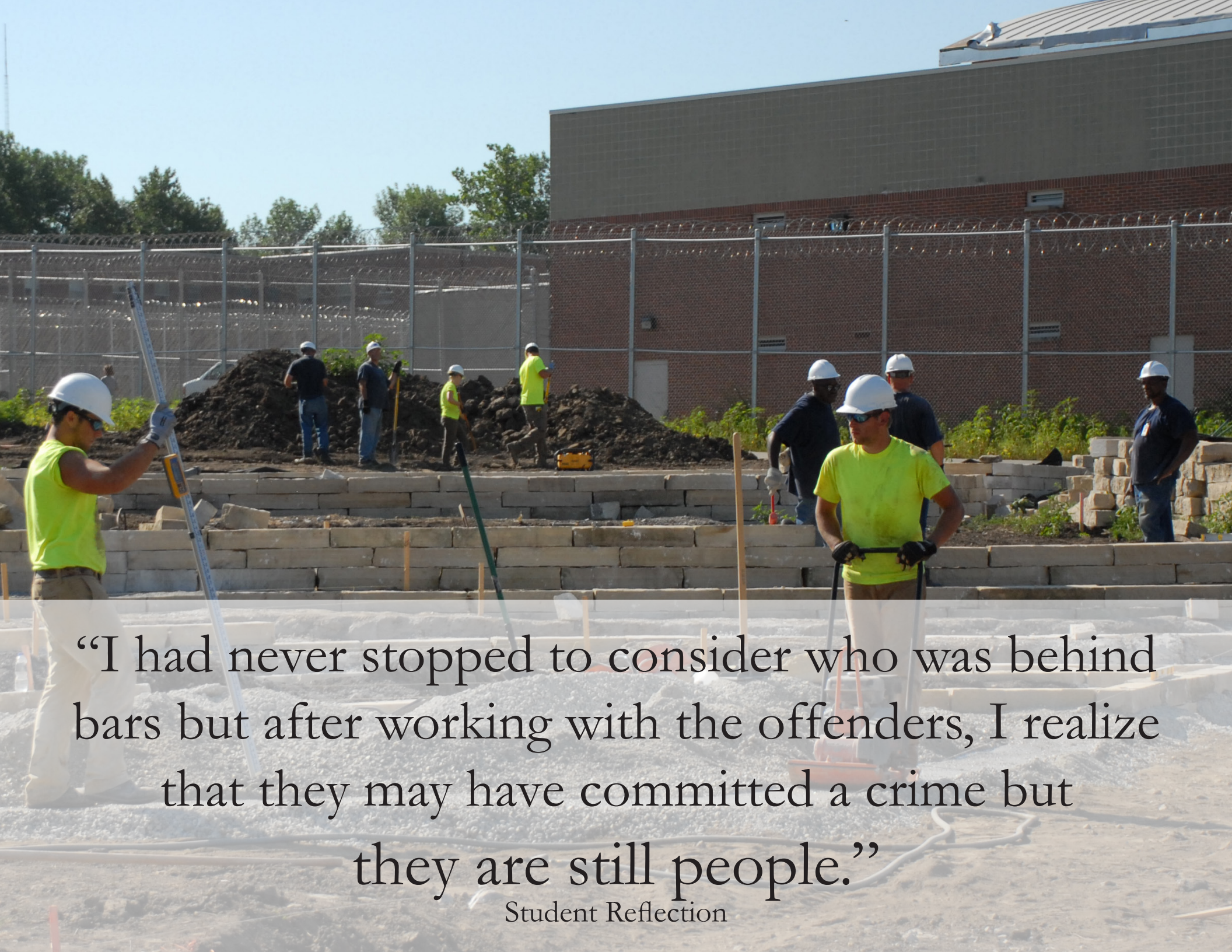

“I had never stopped to consider who was behind bars but after working with the offenders, I realize that they may have committed a crime but they are still people.”

Student Reflection

